

Angular Contact Ball Bearings

Brass cage angular contact ball bearing-7212 BECBY

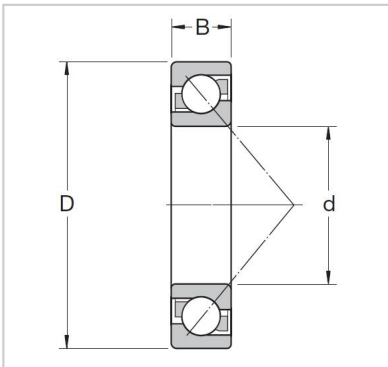

Abutment and fillet dimensions

Db max. **7212 BECBY**

Da max.

da min. 60

rb max. 110

ra max. 22

Dimensions

a 57.2

r3,4 min. 45.5

r1,2 min 1.93

D1 7 000

d2 7 000

d1 0.8

Mass

KG 79.6

Speed ratings r/min

Limiting speed 69.3

Reference speed 91.6

Fatigue load limit

Pu kN 1.5

Basic load ratings KN

dynamic C kN **1**

static Co kN 47

Basic design bearing

B mm 69

D mm 101

d mm 104

Basic design bearing 1.5

Designations

Universally matchable bearing **1**